



Rabournmead Drive, Northolt, UB5 6YJ

SIX MONTH LET - We are delighted to present to the market this well presented two bedroom semi detached bungalow set on this ever popular development. The property includes: two bedrooms, modern bathroom suite, kitchen, and lounge. The property benefits: electric heating, double glazing, good size private rear garden and off street parking. Raboummead Drive is situated within walking distance to both Northolt and South Ruislip's amenities which include local shops, eateries, bus and rail links (Central Line). The A40 is within striking distance offering swift and easy access to both Central London and the Home Counties.





### DISTANCE TO STATION

South Ruislip (0.7 Miles) - Central and Chiltern Line  
Northolt (0.8 Miles) Centrsl line

### COUNCIL TAX

London Borough of Hillingdon - Band C

### UNFURNISHED

### AVAILABILITY

Available from the 1st November

### MANAGED BY LANDLORD

### PARKING

Driveway and no restricted parking on the street.

### Full Description

### SIX MONTH LET



92 High Street, Ruislip, Middlesex, HA4 8LS

T: 01895 625999

[lettings@gibsonhoney.co.uk](mailto:lettings@gibsonhoney.co.uk)

[www.gibsonhoney.co.uk](http://www.gibsonhoney.co.uk)

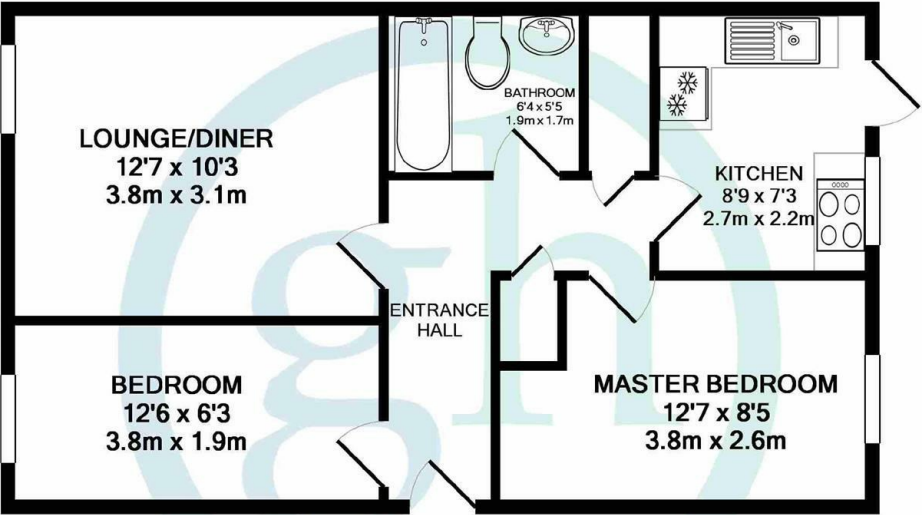

TOTAL APPROX. FLOOR AREA 482 SQ.FT. (44.8 SQ.M.)

Whilst every attempt has been made to ensure the accuracy of the floor plan contained here, measurements of doors, windows, rooms and any other items are approximate and no responsibility is taken for any error, omission, or mis-statement. This plan is for illustrative purposes only and should be used as such by any prospective purchaser. The services, systems and appliances shown have not been tested and no guarantee as to their operability or efficiency can be given  
Made with Metropix ©2018

